

PE Schedule

Saturday, March 5

7:00 - 7:50 am	Breakfast Buffet	Fairfax Dining Room
8:00 - 9:30 am	District Session #3	District Session Locations
9:30 - 9:45 am	BREAK: VISIT EXHIBITORS	
9:45 - 10:45 am	Multi District Breakouts: Session #3	<i>See info on Nametag for location</i>
10:45 - 10:55 am	BREAK: VISIT EXHIBITORS	
10:55 - 11:55 am	Multi District Breakouts: Session #4	<i>PEs stay in same room</i>
11:55 - 12:05 pm	BREAK: VISIT EXHIBITORS	
12:05 - 1:20 pm	Luncheon Plenary Session	Washingtonian
1:20 - 1:30 pm	LAST VISIT TO EXHIBITORS	
1:30 - 2:30 pm	District Session #4	District Session Locations
2:30 pm	Adjourn	

Presidents Nominee Leadership Academy

Saturday, March 5 from 9 am- 2:30 pm [Grand Dominion 3](#)

Asst. Governors Seminar All sessions [Grand Dominion 4](#)

DGN/DGND Roundtable #4 [Franklin](#)



Wifi pw: **cpets22**



Event Code: **CPETS2022**



Visit our CPETS Exhibitors

Located on both lower & upper floors

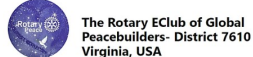

www.ChesapeakePETS.org

Get Social with CPETS



#CPETS22 #LeadersOfAction

All District Sessions

- District 7600 - [Lincoln Forum](#)
- District 7610 - [Grand Dominion 5](#)
- District 7620 - [Grand Dominion 1-2](#)
- District 7630 - [Grand Dominion 6](#)

Multi District Break Out Sessions

Attn PEs: your section number is on your badge.

Friday	Saturday	
1	A	Jeffersonian 1
2	B	Jeffersonian 2
3	C	Jeffersonian 3
4	D	Jeffersonian 4
5	E	Jeffersonian 5
6	F	Jeffersonian 6
7	G	Adams
8	H	Hamilton
9	I	Westcott
10	-	Grand Dominion 3
-	J	Treaty

Easy to Check Your Personal Schedule On Your Smartphone, Tablet, or Any Web Browser at MyEvent.DACdb.com

- Registrants: open web browser on your device & then
- Go to: MyEvent.DACdb.com
- Be sure you're logged in with your Rotary credentials
- For Event Code, type **CPETS2022** (case sensitive)
- *Voila!* Use the menu options to easily find & navigate the event Agenda, sessions & room names, hotel map, exhibitors, attendees & contact info (DACdb profiles).
- Be sure to bookmark the site, for easy instant access while you're at #CPETS22 -- as well as for future reference to stay in touch with new colleagues!

All room locations are at My Event site. No need for printed program book!

QUICK REFERENCE GUIDE #CPETS22



Wifi pw: **cpets22**



Westfields Floor Plan

Reminder: Sessions & room locations are in the [DACdb My Event](#) App!

Wifi pw: **cpets22**

Main Floor

Visit our CPETS Exhibitors!

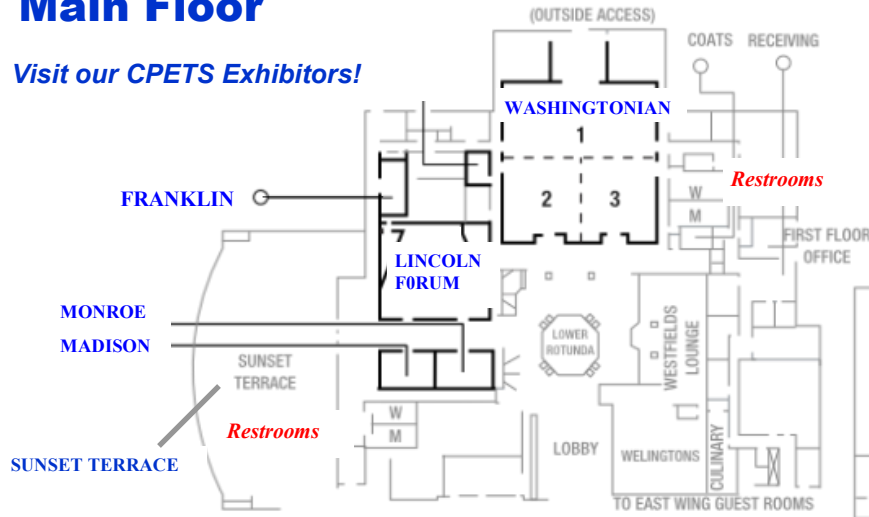

2nd Level

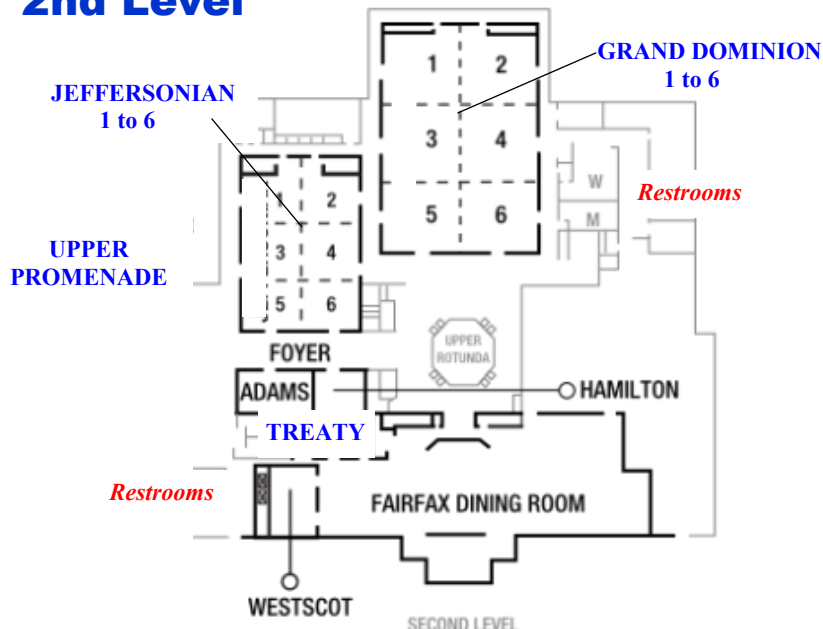

Chesapeake Presidents Elect Training Seminar



PE Schedule

Thursday, March 3, 2022

- 11 am - 4:00 pm Check in & Registration [Lower Rotunda](#)
- 1:00 - 4:15 pm Club President 101 [Grand Dominion 4](#)
- 2:30 - 3:30 pm * Technology 101 (RCC & DACdb) [Adams](#)
- * Risky Business: RI Insurance [Hamilton](#)
- 3:30 - 4:30 pm Rotary Club Formats [Grand Dominion 3](#)
- 6:00 - 8:30 pm Informal Dinner [Washingtonian Ballroom](#)

Friday, March 4

Wifi pw: **cpets22**

- 7:00 - 8:30 am Breakfast on your own
- 8:30 - 10:00 am Registration/Fellowship. Exhibitors may be open
- 9:30 - 10:00 am DGEs. AGs, PNs Team Building [Grand Dominion 3](#)
- 10:00 - 11:30 am District Session #1 [District Session Locations](#)
- 11:30 - 11:50 am BREAK: VISIT EXHIBITORS
- 11:50 - 1:10 pm Luncheon Plenary Session [Washingtonian](#)
- 1:10 - 1:30 pm BREAK: VISIT EXHIBITORS
- 1:30 - 2:30 pm Multi District Break Outs: Session #1
[See session info on your Nametag](#)
- 2:30 - 2:45 pm BREAK: VISIT EXHIBITORS
- 2:45 - 3:45 pm Multi District Break Outs: Session #2
[PEs stay in same room](#)
- 3:45 - 4:10 pm BREAK: VISIT EXHIBITORS
- 4:10 - 5:30 pm District Session #2 [District Session Locations](#)
- 5:30 - 6:15 pm BREAK: VISIT EXHIBITORS
- 6:15 - 7:00 pm Reception (Cash Bar) [Upper Rotunda](#)
- 7:00 - 8:30 pm Dinner Plenary Session [Washingtonian Ballroom](#)
- 8:30 - 8:45 pm District Group Photos [Lower Rotunda](#)
- 8:45 - 10:00 pm Dessert with DGEs [Sunset Terrace \(West Lobby\)](#)

Easy to Check your Personal Schedule on your Smartphone, Table, or Any Web Browser at [MyEvent.DACdb.com](#)



Event Code: **CPETS2022**